

Connectors, Joiners & Clamps

GROUNDING BUSBAR CONNECTOR, SOLID ROUND CONDUCTOR

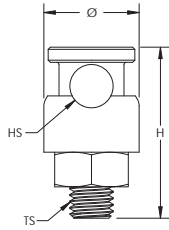

FEATURES

- Used to connect solid round conductors to grounding busbars

Material: Copper Alloy, Stainless Steel 18-8 (EN 1.4305)

Finish: Tinned

Part Number	Height	Diameter	Hole Size	Thread Size	Cu-Bond Conductor	Complies With
223BCR8T	50 mm	20 mm	9.5 mm	M10	CBSC8	IEC [®] 62561-1

IEC compliance is valid only for nVent ERICO Cu-Bond Conductors listed.

STAMPED BONDING PLATE

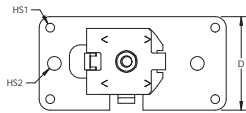

FEATURES

- Stamped bonding plate suitable for structural steel applications
- Listed to UL[®] 96

Conductor Size, UL: Class 1 - Class 2 (4/0 Max)



Part Number	Contact Area	Depth	Height	Width	Hole Size 1	Hole Size 2	Unit Weight
Material: Copper — Finish: Bare							
223LPC540L	51.6 cm ² Min	53.98 mm	31.75 mm	107.95 mm	5.1 mm	7.9 mm	0.254 kg
Material: Copper — Finish: Tinned							
223LPC540L	51.6 cm ² Min	53.98 mm	31.75 mm	107.95 mm	5.1 mm	7.9 mm	0.254 kg

Stainless steel separator included with LPC540A for bi-metallic applications.

BONDING PLATE

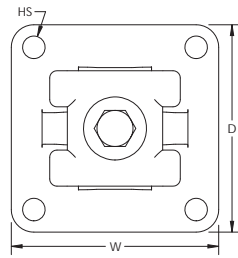

FEATURES

- Cast bonding plate for structural steel applications
- Listed to UL [®] 96

Conductor Size, UL: Class 1 - Class 2 (4/0 Max)



Part Number	Contact Area	Depth	Height	Width	Hole Size	Unit Weight
Material: Brass						
223LPC5322	51.6 cm ² Min	73.03 mm	16.76 mm	73.025 mm	79.38 mm	0.290 kg
Material: Brass — Finish: Tinned						
223LPC532L	51.6 cm ² Min	73.03 mm	16.76 mm	73.025 mm	79.38 mm	0.290 kg

CAST BEAM BONDING CLAMP

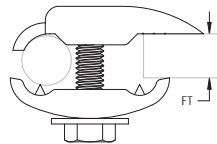

FEATURES

- Clamp for bonding cable to flat metal objects such as I-beams, angle irons and channel irons
- Listed to UL [®] 96

Conductor Size, UL: Class 1 - Class 2 (4/0 Max)



Part Number	Flange Thickness	Depth	Width	Unit Weight
Material: Copper — Finish: Bare				
223LPC559	6.4 mm Max	57.15 mm	40.6 mm	0.175 kg
Material: Copper — Finish: Tinned				
223LPC559L	6.4 mm Max	57.15 mm	40.6 mm	0.175 kg

CAST TWO BOLT BEAM BONDING CLAMP

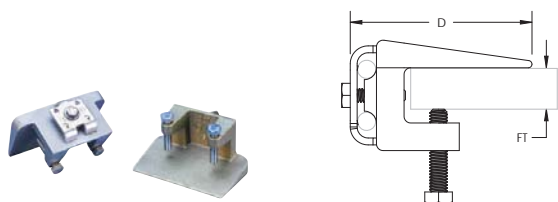

FEATURES

- Clamp for bonding cable to flat metal objects such as I-beams, angle irons and channel irons
- Listed to UL * 96



Conductor Size, UL: Class 1 - Class 2 (4/0 Max)

Part Number	Flange Thickness	Depth	Height	Width	Contact Area	Unit Weight
Material: Copper						
223LPC557	25.4 mm Max	69.85 mm	50.8 mm	101.6 mm	51.613 mm ² Min	0.932 kg
Material: Copper — Finish: Tinned						
223LPC557L	25.4 mm Max	69.85 mm	50.8 mm	101.6 mm	51.613 mm ² Min	0.932 kg

BEAM CLAMP FOR SOLID ROUND CONDUCTOR

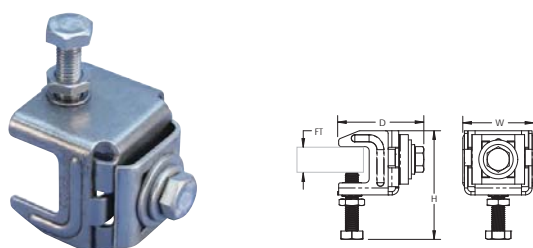

FEATURES

- Clamp for attaching solid round conductor such as Cu-Bond Round Conductor to flat metal objects such as I-beams, angle irons and channel irons
- For use with copper-bonded, copper, or stainless steel solid conductors

Material: Stainless Steel 316 (EN 1.4401)

Part Number	Width	Height	Depth	Flange Thickness	ERICO Cu-Bond Conductor	Unit Weight	Complies With
223SBCS0810	55 mm	85 mm	70 mm	6 – 25 mm	CBSC8, CBSC10	0.277 kg	IEC * 62561-4
223SBCS1314	55 mm	90 mm	70 mm	6 – 25 mm	CBSC13, CBSC14	0.277 kg	IEC * 62561-4

IEC compliance is valid only for Cu-Bond Conductors listed.

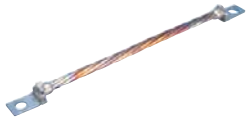

FEATURES

- Made with bare annealed copper cable
- Tinned copper NEMA * lugs welded to the cable with nVent ERICO Cadweld connections

Prefabricated lug bonds are custom made to specifications. Common usage includes cable tray bonding and grounding, structure bonds, surge arrester leads and power jumpers.

Material: Copper
Finish: Tinned

Part Number	Conductor Size	Number of Wires	Length 1	Length 2	Width	Thickness	Hole Size	Angle
Lug Configuration: B212								
223B2121L8	#4 Stranded	7	203 mm	37.3 mm	25.4 mm	4.8 mm	14.3 mm	
223B2121V12	#2 Stranded	7	305 mm	37.3 mm	25.4 mm	4.8 mm	14.3 mm	
223B2122G16	2/0 Stranded	7	406 mm	37.3 mm	25.4 mm	4.8 mm	14.3 mm	
223B2122Q00318	4/0 Stranded	7	8,077 mm	37.3 mm	25.4 mm	4.8 mm	14.3 mm	
223B2122Q20	4/0 Stranded	7	508 mm	37.3 mm	25.4 mm	4.8 mm	14.3 mm	
223B2122Q24	4/0 Stranded	7	610 mm	37.3 mm	25.4 mm	4.8 mm	14.3 mm	
Lug Configuration: B213								
223B2131L15	#4 Stranded	7	381 mm	82.6 mm	25.4 mm	4.8 mm	14.3 mm	
223B2131L20	#4 Stranded	7	508 mm	82.6 mm	25.4 mm	4.8 mm	14.3 mm	
223B2131L22	#4 Stranded	7	559 mm	82.6 mm	25.4 mm	4.8 mm	14.3 mm	
223B2131L24	#4 Stranded	7	610 mm	82.6 mm	25.4 mm	4.8 mm	14.3 mm	
223B2131L28	#4 Stranded	7	711 mm	82.6 mm	25.4 mm	4.8 mm	14.3 mm	
223B2131L32	#4 Stranded	7	813 mm	82.6 mm	25.4 mm	4.8 mm	14.3 mm	
223B2131L35	#4 Stranded	7	889 mm	82.6 mm	25.4 mm	4.8 mm	14.3 mm	
223B2131L38	#4 Stranded	7	965 mm	82.6 mm	25.4 mm	4.8 mm	14.3 mm	
223B2131L42	#4 Stranded	7	1,067 mm	82.6 mm	25.4 mm	4.8 mm	14.3 mm	
223B2131L44	#4 Stranded	7	1,118 mm	82.6 mm	25.4 mm	4.8 mm	14.3 mm	
223B2131V18	#2 Stranded	7	457 mm	82.6 mm	25.4 mm	4.8 mm	14.3 mm	
223B2131V36	#2 Stranded	7	914 mm	82.6 mm	25.4 mm	4.8 mm	14.3 mm	
223B2132G11	2/0 Stranded	7	279 mm	82.6 mm	25.4 mm	4.8 mm	14.3 mm	
223B2132G14	2/0 Stranded	7	356 mm	82.6 mm	25.4 mm	4.8 mm	14.3 mm	
223B2132Q18	4/0 Stranded	7	457 mm	82.6 mm	25.4 mm	4.8 mm	14.3 mm	
223B2132Q36	4/0 Stranded	7	914 mm	82.6 mm	25.4 mm	4.8 mm	14.3 mm	
223B2132Q48	4/0 Stranded	7	1,219 mm	82.6 mm	25.4 mm	4.8 mm	14.3 mm	
223B2132Q54	4/0 Stranded	7	1,372 mm	82.6 mm	25.4 mm	4.8 mm	14.3 mm	
223B2132Q60	4/0 Stranded	7	1,524 mm	82.6 mm	25.4 mm	4.8 mm	14.3 mm	
223B2132V18	250 kcmil Stranded	19	457 mm	82.6 mm	25.4 mm	4.8 mm	14.3 mm	
Lug Configuration: B216								
223B2162C72	1/0 Stranded	7	1,829 mm	37.3 mm	25.4 mm	4.8 mm	14.3 mm	
223B2162C96	1/0 Stranded	7	2,438 mm	37.3 mm	25.4 mm	4.8 mm	14.3 mm	
223B2162Q24	4/0 Stranded	7	610 mm	37.3 mm	25.4 mm	4.8 mm	14.3 mm	
223B2162Q8	4/0 Stranded	7	203 mm	37.3 mm	25.4 mm	4.8 mm	14.3 mm	
Lug Configuration: B217								
223B2171L24	#4 Stranded	7	610 mm	82.6 mm	25.4 mm	4.8 mm	14.3 mm	
223B2172C12	1/0 Stranded	7	305 mm	82.6 mm	25.4 mm	4.8 mm	14.3 mm	
223B2172G24	2/0 Stranded	7	610 mm	82.6 mm	25.4 mm	4.8 mm	14.3 mm	
223B2172Q00196	4/0 Stranded	7	4,978 mm	82.6 mm	25.4 mm	4.8 mm	14.3 mm	
223B2172Q12	4/0 Stranded	7	305 mm	82.6 mm	25.4 mm	4.8 mm	14.3 mm	
223B2172Q24	4/0 Stranded	7	610 mm	82.6 mm	25.4 mm	4.8 mm	14.3 mm	

Part Number	Conductor Size	Number of Wires	Length 1	Length 2	Width	Thickness	Hole Size	Angle
Lug Configuration: B218								
223B2182Q30	4/0 Stranded	7	762 mm	37.3 mm	25.4 mm	4.8 mm	14.3 mm	45°
Lug Configuration: B219								
223B2192C12	1/0 Stranded	7	305 mm	82.6 mm	25.4 mm	4.8 mm	14.3 mm	45°
223B2192Q08	4/0 Stranded	7	203 mm	82.6 mm	25.4 mm	4.8 mm	14.3 mm	45°
223B2192Q12	4/0 Stranded	7	305 mm	82.6 mm	25.4 mm	4.8 mm	14.3 mm	45°

LAY-IN LUG

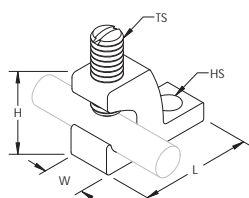
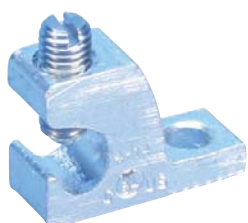

FEATURES

- Often used in solar bonding lug applications
- Lay-in features allows for easy positioning
- Set screw hardware made of 304 stainless steel

Material: Copper, Stainless Steel 304 (EN 1.4301)
Finish: Tinned



Part Number	Length	Width	Height	Hole Size	Thread Size	Conductor Size
223EL6CADB	26.4 mm	9.9 mm	19.3 mm	5.58 mm	1/4 NF	#14 Solid - #4 Stranded, 2.5 mm ² Stranded - 16 mm ² Stranded

SOLAR BONDING LUG

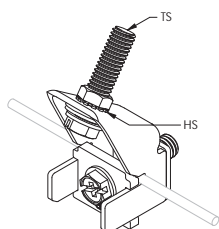

FEATURES

- Bonds the frames and mounting structures of solar photo voltaic systems in accordance with NEC[®] requirements
- Copper alloy is corrosion resistant and galvanically compatible with copper grounding conductors and aluminum photovoltaic module frames
- Lay-in feature allows for easy positioning along multiple frames

Material: Bronze, Stainless Steel 18-8 (EN 1.4305)
Finish: Tinned



Part Number	Direct Burial	Conductor Size	Hole Size	Screw Included	Thread Size
223EL6CS	No	#14 Solid - #6 Stranded	5.61 mm	Yes	10 UNS
223EL6CS8	No	#14 Solid - #6 Stranded	5.61 mm	Yes	8 UNS
223EL6CSDB	Yes	#14 Solid - #6 Stranded	5.61 mm	Yes	10 UNS
223EL6CSDB8	Yes	#14 Solid - #6 Stranded	5.61 mm	Yes	8 UNS
223EL6CSDBNH	Yes	#14 Solid - #6 Stranded	5.61 mm	No	
223EL6CSNH	No	#14 Solid - #6 Stranded	5.61 mm	No	

EARTH BOSS

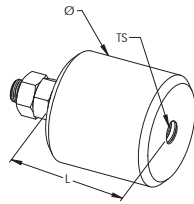

FEATURES

- Provides preferential equipotential bonding connection point

Material: Stainless Steel 316 (EN 1.4401), Steel

Part Number	Article Number	Length	Diameter	Thread Size
22350010EBOSS	710160	50 mm	50 mm	M10

The surface of the earth boss needs to be cleaned before welding. Welding procedures vary, depending on the type of steel used.

516 PARALLEL CABLE CONNECTOR

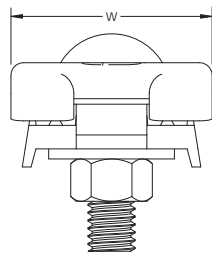

FEATURES

- Cable splice with positive single bolt tension grip on cable or wire
- For use with all full size cables on Class I/II structures
- Listed to UL * 96

Conductor Size, UL: Class 1 - Class 2 (4/0 Max)



Part Number	Depth	Width	Unit Weight
Material: Copper — Finish: Bare			
223LPC516	46.74 mm	38.1 mm	0.181 kg
Material: Copper — Finish: Tinned			
223LPC516L	46.74 mm	38.1 mm	0.181 kg

517 PARALLEL CABLE CONNECTOR

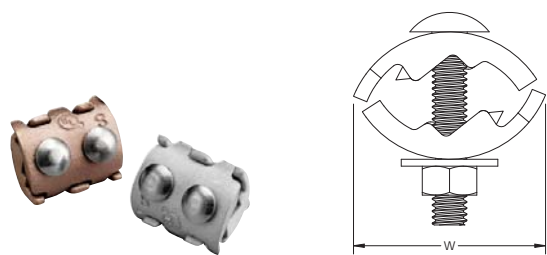

FEATURES

- Cable splice with positive two bolt tension grip on cable or wire
- For use with all full size cables on Class I/II structures
- Listed to UL * 96



Conductor Size, UL: Class 1 - Class 2 (4/0 Max)

Part Number	Depth	Width	Unit Weight
Material: Copper			
223LPC517	48.51 mm	42.16 mm	0.233 kg
Material: Copper — Finish: Tinned			
223LPC517L	48.51 mm	42.16 mm	0.233 kg

CABLE CLAMP

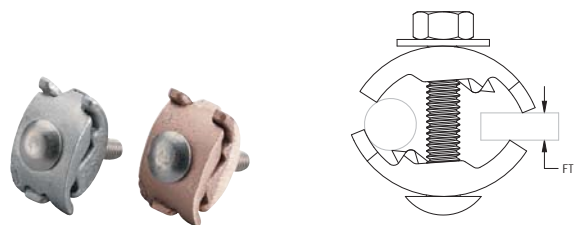

FEATURES

- Clamps to flat metal objects such as I-beams, angle irons and channel irons
- Can be used as a parallel conductor clamp
- Positive bolt tension draws tight on steel member
- Listed to UL * 96



Conductor Size, UL: Class 1 - Class 2 (4/0 Max), Secondary

Part Number	Flange Thickness	Depth	Width	Unit Weight
Material: Brass				
223LPC858	12.7 mm Max	42.16 mm	22.6 mm	0.108 kg
Material: Brass — Finish: Tinned				
223LPC858L	12.7 mm Max	42.16 mm	22.6 mm	0.108 kg

Flange thickness will impact the maximum cable holding capability.

STAMPED BOLTED PARALLEL CABLE CONNECTOR

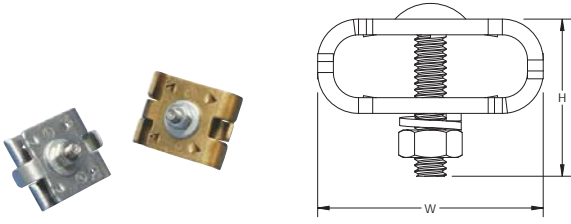

FEATURES

- For positive bolt tension cable clamping
- Listed to UL * 96

Conductor Size, UL: Class 1 - Class 2 (4/0 Max)



Part Number	Depth	Height	Width	Unit Weight
Material: Copper				
223LPC502	38.1 mm	38.1 mm	45.2 mm	0.087 kg
Material: Copper — Finish: Tinned				
223LPC502L	38.1 mm	38.1 mm	45.2 mm	0.087 kg

Stainless steel separator included with LPC502A for bi-metallic applications.

JUMPER CLAMP FOR TELECOM

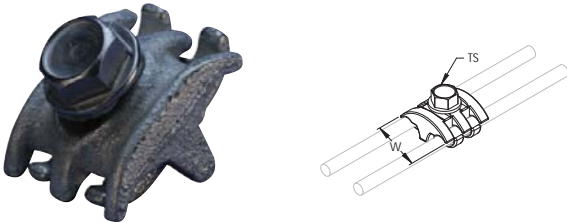

FEATURES

- For use in telecom applications

Material: Bronze
Finish: Tinned



Part Number	Width	Thread Size	Conductor Size
223KUL	35.6 mm	5/16 UNC	#6 Solid

Although a #6 Solid conductor is similar in size to a metric 16 mm² Solid conductor, the UL listing is currently only for #6 Solid.

CROSS-RUN CABLE CONNECTORS, SOLID ROUND CONDUCTOR

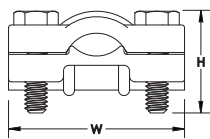

FEATURES

- Can be used as a cross-run cable connector
- Four bolts for positive bolt tension grip on cables
- For use with Cu-Bond Round Conductors

Material: Brass

Part Number	Depth	Height	Width	Cu-Bond Conductor	Unit Weight	Complies With
223LPC595NB	50.8 mm	25.40 mm	50.8 mm	CBSC8, CBSC10	0.281 kg	IEC * 62561-1
223LPC595NB13	50.8 mm	31.75 mm	50.8 mm	CBSC13	0.281 kg	IEC * 62561-1

IEC compliance is valid only for Cu-Bond Conductors listed.

T-CONNECTOR

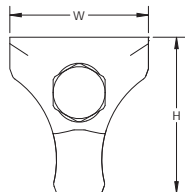

FEATURES

- For 90° conductor connections

Part Number	Article Number	Conductor Size	Depth	Height	Width	Cu-Bond Conductor	Unit Weight	Complies With
Material: Brass								
223CTR8CU	710030	8 mm Solid, 10 mm Solid	21.0 mm	46.0 mm	40.0 mm	CBSC10	0.168 kg	IEC * 62561-1
Material: Zinc Alloy								
223CTR10	101230	8 mm Solid, 10 mm Solid	20.4 mm	48.7 mm	26.4 mm		0.120 kg	

IEC compliance is valid only for Cu-Bond Conductors listed.

IN-LINE CABLE CONNECTOR

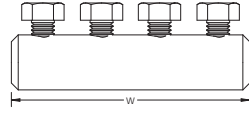

FEATURES

- Cable splicer with four bolts for pressure on each cable
- LPC513 is compatible with Cu-Bond Round Conductors

Conductor Size, UL: Class 1 - Class 2 (4/0 Max)



Part Number	Diameter 1	Diameter 2	Width	Cu-Bond Conductor	Unit Weight	Complies With
Material: Copper						
223LPC513	19.1 mm	14.3 mm	82.55 mm	CBSC8, CBSC10, CBSC13	0.168 kg	IEC* 62561-1
Material: Copper — Finish: Tinned						
223LPC513L	19.1 mm	14.3 mm	82.55 mm		0.168 kg	

IEC compliance is valid only for Cu-Bond Conductors listed.

MESH BONDING NETWORK CONNECTOR, MBNC240

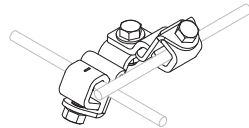

FEATURES

- Allows for fast, simple and economical field connection of grounding and bonding wires
- Heavy duty clamps with stainless steel hardware are suitable for direct burial
- Can accommodate additional pigtails that can be used to connect to building steel and equipment
- Can be combined with Universal Pedestal Clamp for bonding to various pedestal sizes for mesh bonding networks

Material: Copper, Stainless Steel 304 (EN 1.4301)



Part Number	Conductor Size	Cu-Bond Conductor	Complies With	Standard Packaging Quantity
223MBNC240	#2 Solid - 4/0 Stranded, 35 mm ² - 100 mm ²	CBSC8, CBSC10, CBSC13	IEC* 62561-1	25 pc

IEC compliance is valid only for Cu-Bond Conductors listed.

MESH BONDING NETWORK CONNECTOR, MBNC240A

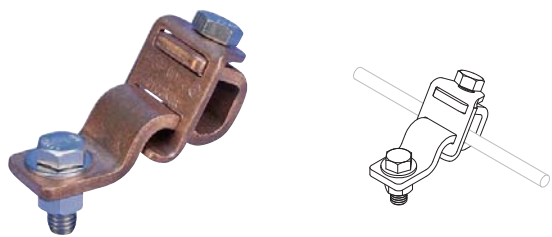

Material: Copper, Stainless Steel 304 (EN 1.4301)

FEATURES

- Allows for fast, simple and economical field connection of grounding and bonding wires
- Heavy duty clamps with stainless steel hardware are suitable for direct burial
- Can be combined with Universal Pedestal Clamp for bonding to various pedestal sizes for mesh bonding networks



Part Number	Conductor Size	Standard Packaging Quantity
223MBNC240A	#2 Solid - 4/0 Stranded, 35 mm ² - 100 mm ²	25 pc

MESH BONDING NETWORK CONNECTOR, MBNC82

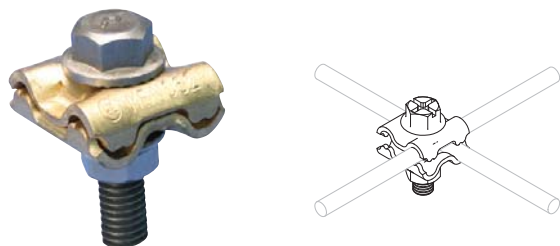

Material: Bronze, Stainless Steel 304 (EN 1.4301)

FEATURES

- Allows for fast, simple and economical field connection of grounding and bonding wires
- Heavy duty clamps with stainless steel hardware are suitable for direct burial
- Can accommodate additional pigtails that can be used to connect to building steel and equipment
- Can be combined with Universal Pedestal Clamp for bonding to various pedestal sizes for mesh bonding networks



Part Number	Conductor Size	Standard Packaging Quantity
223MBNC82	#8 Solid - #2 Stranded, 10 mm ² Solid - 35 mm ² Stranded	25 pc

SRG CONNECTOR

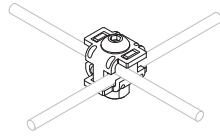

FEATURES

- Allows for fast, simple and economical field connection of grounding and bonding wires
- Heavy duty clamps with stainless steel hardware are suitable for direct burial
- Can accommodate additional pigtails that can be used to connect to building steel and equipment
- Can be combined with Universal Pedestal Clamp for bonding to various pedestal sizes for mesh bonding networks

Material: Bronze, Stainless Steel 304 (EN 1.4301)



Part Number	Article Number	Conductor Size
223SRGC46	167905	#6 Solid - #4 Stranded, 16 mm ² Stranded

SPLIT BOLT CONNECTOR

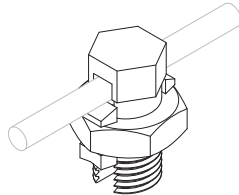

FEATURES

- Unplated high-strength silicon bronze accommodates copper to copper connections
- Tin plated, high-strength copper alloy split bolt with spacer separates dissimilar conductors and accommodates copper-to-copper, copper-to-aluminum and aluminum-to-aluminum connections

Material: Silicon Bronze



Part Number	Conductor Size	Certifications
Tin Plating: No		
223ESB8	#16 Stranded - #8 Stranded, 1.5 mm ² Stranded - 6 mm ² Stranded	cULus
223ESB6	#10 Solid - #6 Stranded, 6 mm ² Stranded - 10 mm ² Stranded	cULus
223ESB4	#8 Solid - #4 Solid, 10 mm ² Stranded - 16 mm ² Stranded	cULus
223ESB2	#6 Solid - #2 Stranded, 16 mm ² Stranded - 25 mm ² Stranded	cULus
223ESB2/0	#2 Solid - 2/0 Stranded, 35 mm ² Stranded - 50 mm ² Stranded	UL
223ESB4/0	1/0 Solid - 250 kcmil Stranded, 70 mm ² Stranded - 120 mm ² Stranded	
Tin Plating: Yes		
223ESBP8	#14 Stranded - #8 Stranded, 2.5 mm ² Stranded - 6 mm ² Stranded	UL
223ESBP6	#10 Stranded - #6 Stranded, 6 mm ² Stranded - 10 mm ² Stranded	UL
223ESBP4	#8 Solid - #3 Stranded, 10 mm ² Stranded - 25 mm ² Stranded	UL
223ESBP2	#8 Solid - #2 Stranded, 10 mm ² Stranded - 25 mm ² Stranded	UL
223ESBP2/0	#8 Solid - 2/0 Stranded, 10 mm ² Stranded - 50 mm ² Stranded	UL
223ESBP1/0	#6 Solid - 1/0 Stranded, 16 mm ² Stranded - 50 mm ² Stranded	UL
223ESBP4/0	#4 Stranded - 250 kcmil Stranded, 25 mm ² Stranded - 120 mm ² Stranded	
223ESBP350	3/0 Stranded - 350 kcmil Stranded, 95 mm ² Stranded - 150 mm ² Stranded	

Oxide inhibitor recommended when used on aluminum conductor.

WISE CLAMP

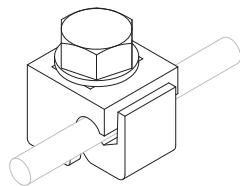

FEATURES

- Used to splice two conductors together

Material: Bronze

Part Number	Conductor Size
223VC62	#6 Solid - #2 Solid, 16 mm ² Solid - 25 mm ² Solid

WISE CLAMP FOR TELECOM

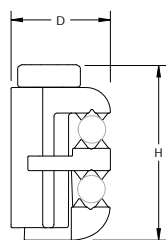

FEATURES

- Used to bond messenger wire to ground tap conductors
- When clamp is tightened, the piercing teeth puncture the insulation on the messenger wire, forming a positive ground connection without stripping the cable

Material: Copper Alloy, Stainless Steel 304 (EN 1.4301)

Finish: Tinned

Part Number	Height	Width	Depth	Diameter	Thread Size	Unit Weight
223EVC167P	41.3 mm	31.8 mm	25.4 mm	3.7 – 7.9 mm	5/16 UNC	0.1 kg

MULTI-PURPOSE GROUNDING CLAMP

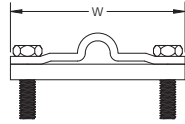

FEATURES

- Cross connector for round to round, round to tape, and tape to tape connections

Part Number	Article Number	Conductor Size	Tape Size	Depth	Width	Unit Weight
Material: Brass						
223CCFR308	545270	8 mm ² Stranded, 8 mm ² Solid	25 x 3 mm, 26 x 2 mm	56 mm	56 mm	0.15 kg
Material: Stainless Steel 304 (EN 1.4301)						
223CCS-308	545170	8 mm ² Stranded, 8 mm ² Solid	25 x 3 mm, 26 x 2 mm	56 mm	56 mm	0.15 kg
Material: Steel — Finish: Hot-Dip Galvanized						
223CCG308	545180	8 mm ² Stranded, 8 mm ² Solid	25 x 3 mm, 26 x 2 mm	56 mm	56 mm	0.15 kg

MULTI-PURPOSE GROUNDING CLAMP, STAINLESS STEEL

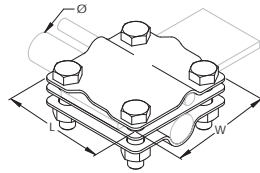
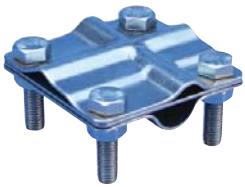

FEATURES

- Convenient multi-purpose clamp designed to accommodate round conductors, flat conductors, ground rods and rebar
- Stainless steel material with inner plate allows compatibility between most dissimilar metals

Material: Stainless Steel 304 (EN 1.4301)
 Conductor Size: 35 mm² Stranded - 50 mm² Stranded, #2 Stranded - 1/0 Solid
 Tape Size: 40 x 4 mm Max

Part Number	Article Number	Ground Rod Diameter, Nominal	Ground Rod Diameter, Actual	Rebar Size, Metric	Rebar Size, US	Rebar Size, Canada	Length	Width
223MPSC404SS	120319	5/8" - 3/4"	14.2 - 19.0 mm	16 - 20 mm	#5 - #6	15M - 20M	65 mm	65 mm

UNIVERSAL CLAMP, SOLID ROUND CONDUCTOR

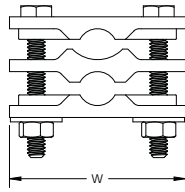

FEATURES

- For parallel connections of Cu-Bond Round Conductor

Material: Brass

Part Number	Depth	Width	CU-BOND Conductor	Unit Weight	Complies With
LPC466B	31.7 mm	63.5 mm	CBSC10, CBSC13	0.279 kg	IEC* 62561-1

IEC compliance is valid only for Cu-Bond Conductors listed.

WATER PIPE GROUND CLAMP

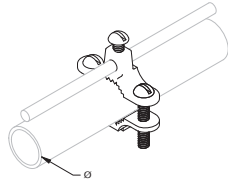

FEATURES

- High-strength silicone bronze
- Used for connecting copper conductors to metallic water pipe or ground rods



Part Number	Article Number	Pipe Size, Nominal	Pipe Size, Actual	Conductor Size	Certifications
Material: Silicon Bronze					
223CWP1JJ	710262	1/2" – 1"	12.7 – 25.4 mm	#10 Solid - #4 Stranded, 6 mm ² Stranded - 16 mm ² Stranded	
223CWP1JU	710266	1/2" – 1"	12.7 – 25.4 mm	#10 Solid - #2 Stranded, 6 mm ² Stranded - 25 mm ² Stranded	CSA, cULus
223CWP2JU	710267	1 1/4" – 2"	31.8 – 50.8 mm	#10 Solid - #2 Stranded, 6 mm ² Stranded - 25 mm ² Stranded	CSA, cULus
223CWP4J	710264	2 1/2" – 4"	63.5 – 101.6 mm	#10 Solid - #4 Stranded, 6 mm ² Stranded - 16 mm ² Stranded	CSA, cULus
223CWP6J	710265	4 1/2" – 6"	108.0 – 152.4 mm	#10 Solid - #4 Stranded, 6 mm ² Stranded - 16 mm ² Stranded	CSA
Material: Zinc Alloy					
223ZWP1J	710268	1/2" – 1"	12.7 – 25.4 mm	#10 Solid - #6 Solid, 6 mm ² Stranded - 10 mm ² Stranded	cULus

Optional copper screw for use in direct burial applications.

WATER/GAS PIPE GROUND CLAMP

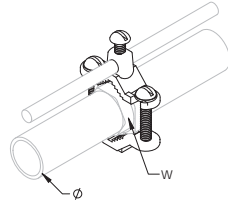

FEATURES

- High-strength silicone bronze
- Used for connecting copper conductors to metallic water pipe, ground rods, or flexible gas pipe (CSST) with brass hex fittings
- Conform to the requirements of the 2009 edition of NFPA[®] 54, NFGC[®] (National Fuel Gas Code) and NEC[®] (National Electric Code) for bonding corrugated stainless steel tubing (CSST) gas piping systems to the grounding conductor of the building's electrical system
- SH version for outdoor applications



Material: Silicon Bronze

Part Number	Article Number	Pipe Size, Nominal	Pipe Size, Actual	Hex Width	Conductor Size	Certifications
For Outdoor Use: No						
223CWP1J	710261	1/2" – 1"	12.7 – 25.4 mm	25.4 – 31.8 mm	#10 Solid - #2 Solid, 6 mm ² Solid - 25 mm ² Stranded	CSA, cULus
223CWP2J	710263	1 1/4" – 2"	31.8 – 50.8 mm	38.1 – 54.0 mm	#10 Solid - #2 Stranded, 6 mm ² Stranded - 25 mm ² Stranded	CSA, cULus
223CWP3J		2 1/2" – 4"	63.5 – 101.6 mm	63.5 – 79.4 mm	#10 Solid - #4 Stranded, 6 mm ² Stranded - 16 mm ² Stranded	cULus
For Outdoor Use: Yes						
223CWP1JSH		1/2" – 1"	12.7 – 25.4 mm	25.4 – 31.8 mm	#10 Solid - #2 Stranded, 6 mm ² Stranded - 25 mm ² Stranded	cULus
223CWP2JSH		1 1/4" – 2"	31.8 – 50.8 mm	38.1 – 54.0 mm	#10 Solid - #2 Stranded, 6 mm ² Solid - 25 mm ² Stranded	cULus
223CWP3JSH		2 1/2" – 4"	63.5 – 101.6 mm	63.5 – 79.4 mm	#10 Solid - #4 Stranded, 6 mm ² Stranded - 16 mm ² Stranded	cULus

CAST PIPE CLAMP

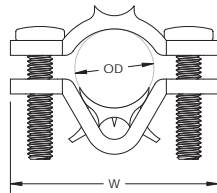

FEATURES

- Clamp for bonding horizontal or vertical pipes to the lightning protection system
- Listed to UL[®] 96

Conductor Size, UL: Class 1 - Class 2 (4/0 Max), Secondary



Part Number	Outer Diameter	Depth	Width	Unit Weight
Material: Brass — Finish: Bare				
223LPC580	19.1 – 33.5 mm	38.1 mm	69.85 mm	0.268 kg
Material: Brass — Finish: Tinned				
223LPC580L	19.1 – 33.5 mm	38.1 mm	69.85 mm	0.268 kg

CAST U-BOLT PIPE CLAMP

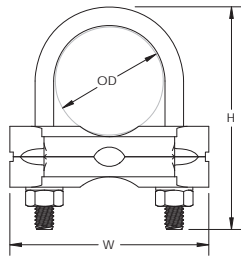

FEATURES

- Clamp for bonding conductor to handrails, pipes and rebar to lightning protection system
- Listed to UL[®] 96



Conductor Size, UL: Class 1 - Class 2 (4/0 Max), Secondary

Part Number	Outer Diameter	Depth	Height	Width	Unit Weight
Material: Brass — Finish: Bare					
223LPC570	17.3 – 38.1 mm	45.72 mm	76.2 mm	67.818 mm	0.324 kg
Material: Brass — Finish: Tinned					
223LPC570L	17.3 – 38.1 mm	45.72 mm	76.2 mm	67.818 mm	0.324 kg

NOTCHED CAST U-BOLT PIPE CLAMP

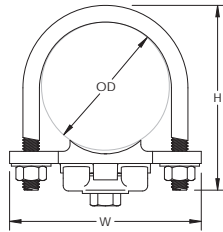

FEATURES

- Clamp for bonding of handrails and pipes to the lightning protection system
- Notched hole makes assembly easy and eliminates loose hardware
- Listed to UL[®] 96



Conductor Size, UL: Class 1 - Class 2 (4/0 Max)

Part Number	Outer Diameter	Depth	Height	Width	Unit Weight
Material: Brass — Finish: Bare					
223LPC571	50.8 – 63.5 mm	49.78 mm	88.9 mm	92.2 mm	0.379 kg
Material: Brass — Finish: Tinned					
223LPC571L	50.8 – 63.5 mm	49.78 mm	88.9 mm	92.2 mm	0.379 kg

STAMPED U-BOLT PIPE CLAMP

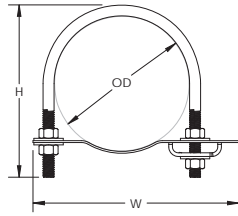

FEATURES

- Clamp for bonding of pipes and exhaust stacks to the lightning protection system
- Listed to UL[®] 96



Part Number	Outer Diameter	Depth	Height	Width	Unit Weight
Material: Copper, Stainless Steel 304 (EN 1.4301)					
223LPC5964	99.1 – 108.0 mm	50.8 mm	147.64 mm	158.75 mm	0.401 kg
223LPC5966	111.1 – 174.2 mm	50.8 mm	223.84 mm	211.15 mm	0.372 kg

STAMPED U-BOLT PIPE CLAMP, 90°

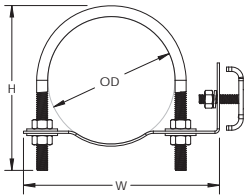

FEATURES

- Clamp for bonding of pipes, handrails and exhaust stacks to the lightning protection system
- Listed to UL[®] 96



Conductor Size, UL: Class 1 - Class 2 (4/0 Max)

Part Number	Outer Diameter	Depth	Height	Width	Unit Weight
Material: Copper, Stainless Steel 304 (EN 1.4301)					
223LPC5962	48.3 – 66.7 mm	50.8 mm	92.00 mm	118.745 mm	0.234 kg
223LPC5963	66.8 – 92.2 mm	50.8 mm	119.19 mm	139.700 mm	0.346 kg

THIN WALL PIPE GROUND CLAMP ASSEMBLY

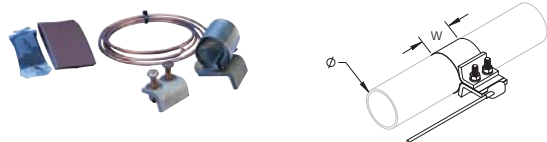

FEATURES

- Tinned copper strap draws tightly around pipe
- All hardware is included
- Includes emery cloth and anti-oxidant compound
- Conductor stub is easily spliced to ground conductor
- Cu-Bond connection of conductor to strap eliminates a mechanical interface

Material: Copper, Silicon Bronze

Finish: Tinned

Part Number	Width	Water Pipe Size	Conductor Size	Cable Length
223B852A12C1G96	50.8 mm	76 – 305 mm	#6 Solid	2.4 m
223B852A12C2Q60	50.8 mm	76 – 305 mm	4/0 Concentric	1.5 m
223B852A8C1G48	50.8 mm	76 – 203 mm	#6 Solid	1.2 m
223B852A8C1G96	50.8 mm	76 – 203 mm	#6 Solid	2.4 m

CABLE/POINT PIPE SUPPORT

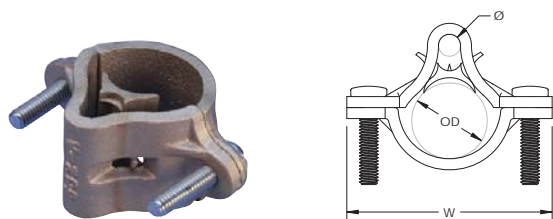

FEATURES

- Clamp for bonding horizontal or vertical pipes to the lightning protection system
- May be used as a vertical support for air terminals
- Listed to UL[®] 96



Part Number	Diameter	Outer Diameter	Depth	Width	Unit Weight
Material: Brass — Finish: Bare					
223LPC330	9.5 mm	35.6 – 44.5 mm	41.28 mm	88.9 mm	0.358 kg
223LPC331	9.5 mm	44.5 – 63.5 mm	41.28 mm	99.0 mm	0.379 kg
Material: Brass — Finish: Tinned					
223LPC330L	9.5 mm	35.6 – 44.5 mm	41.28 mm	88.9 mm	0.358 kg
223LPC331L	9.5 mm	44.5 – 63.5 mm	41.28 mm	99.0 mm	0.379 kg

FENCE CLAMP, ONE CONDUCTOR

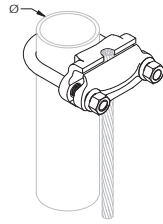

FEATURES

- Theft-deterrent appearance
- Stainless steel hardware included
- Tin plating minimizes the risk of corrosion
- The clamp accepts the conductor either in parallel or at right angles to the pipe

Material: Bronze, Stainless Steel 304 (EN 1.4301)

Finish: Tinned



Part Number	Article Number	Fence Post Size, Nominal	Fence Post Outside Diameter, Actual	Conductor Size	Cu-Bond Conductor	Complies With	Certifications
223FC073	198401	1 1/2"	48 mm	#4 Solid - 2/0 Stranded, 16 mm ² Stranded - 70 mm ² Stranded			
223FC074	198402	1 1/2"	48 mm	2/0 Solid - 250 kcmil Stranded, 50 mm ² Stranded - 120 mm ² Stranded			
223FC075	198403	2"	60 mm	#4 Solid - 2/0 Stranded, 16 mm ² Stranded - 70 mm ² Stranded	CBSC8	IEC [®] 62561-1	cULus
223FC076	198404	2"	60 mm	2/0 Solid - 250 kcmil Stranded, 50 mm ² Stranded - 120 mm ² Stranded	CBSC10, CBSC13	IEC [®] 62561-1	
223FC078	198406	2 1/2"	73 mm	2/0 Solid - 250 kcmil Stranded, 16 mm ² Stranded - 120 mm ² Stranded			
223FC079	198407	3"	89 mm	#4 Solid - 2/0 Stranded, 16 mm ² Stranded - 70 mm ² Stranded			
223FC080	198408	3"	89 mm	2/0 Solid - 250 kcmil Stranded, 50 mm ² Stranded - 120 mm ² Stranded			
223FC082	198411	3 1/2"	102 mm	#4 Solid - 2/0 Stranded, 16 mm ² Stranded - 120 mm ² Stranded			

IEC compliance is valid only for Cu-Bond Conductors listed.

FENCE CLAMP, TWO CONDUCTORS

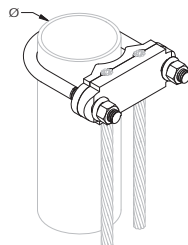

FEATURES

- Theft-deterrent appearance
- Stainless steel hardware included
- Tin plating minimizes the risk of corrosion

Material: Copper Alloy, Stainless Steel 304 (EN 1.4301)

Finish: Tinned



Part Number	Fence Post Size, Nominal	Fence Post Outside Diameter, Actual	Conductor Size
223FC076DH	2"	60.45 mm	2/0 Solid - 250 kcmil Stranded, 50 mm ² Stranded - 120 mm ² Stranded
223FC078DH	2 1/2"	73.15 mm	2/0 Solid - 250 kcmil Stranded, 16 mm ² Stranded - 120 mm ² Stranded
223FC082DH	3 1/2"	101.60 mm	#4 Solid - 2/0 Stranded, 16 mm ² Stranded - 120 mm ² Stranded

FENCE CLAMP FOR FIELD-WELDED CONNECTIONS

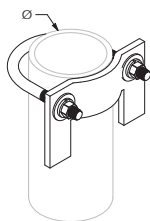

Material: Electrolytic Copper
Finish: Tinned

Part Number	Fence Post Size, Nominal	Fence Post Outside Diameter, Actual
223B522B	1 1/4"	42 mm
223B522C	1 1/2"	48 mm
223B522D	2"	60 mm
223B522E	2 1/2"	73 mm
223B522F	3"	89 mm
223B522G	3 1/2"	102 mm
223B522H	4"	114 mm
223B522K	6"	168 mm

FEATURES

- Ideal for when Cadweld connections cannot be made to aluminum pipe or thin-wall steel tube
- Stainless steel hardware included
- Can be used when field-welding conductors

FLEXIBLE JUMPER FOR FENCE AND GATE GROUNDING



FEATURES

- Used to bond gates, switch operating handles and any other item where movement or vibration requires a flexible grounding jumper
- Multi-stranded insulated ropelay conductor provides flexibility and strand protection
- Swaged ends of jumper allow larger conductor to fit in the same mold as concentric conductor
- Connections are made with Cadweld exothermic connections using the same mold required for other fence post connections

Material: Copper, Polyethylene Rubber

Part Number	Cable Code	Conductor Size	Cable Length
223FJ1T18	1T	#2 Solid	457 mm
223FJ1T24	1T	#2 Solid	610 mm
223FJ1T42	1T	#2 Solid	1,067 mm
223FJ1T96	1T	#2 Solid	2,438 mm
223FJ1T240	1T	#2 Solid	6,096 mm
223FJ2G12	2G	2/0 Stranded	305 mm
223FJ2G16	2G	2/0 Stranded	406 mm
223FJ2G18	2G	2/0 Stranded	457 mm
223FJ2G24	2G	2/0 Stranded	610 mm
223FJ2G30	2G	2/0 Stranded	762 mm
223FJ2G36	2G	2/0 Stranded	914 mm
223FJ2G72	2G	2/0 Stranded	1,829 mm
223FJ2G84	2G	2/0 Stranded	2,134 mm
223FJ2G96	2G	2/0 Stranded	2,438 mm

Part Number	Cable Code	Conductor Size	Cable Length
223FJ2G120	2G	2/0 Stranded	3,048 mm
223FJ2G132	2G	2/0 Stranded	3,353 mm
223FJ2G144	2G	2/0 Stranded	3,658 mm
223FJ2G168	2G	2/0 Stranded	4,267 mm
223FJ2G180	2G	2/0 Stranded	4,572 mm
223FJ2G228	2G	2/0 Stranded	5,791 mm
223FJ2G360	2G	2/0 Stranded	9,144 mm
223FJ2Q16	2Q	4/0 Stranded	406 mm
223FJ2Q18	2Q	4/0 Stranded	457 mm
223FJ2Q24	2Q	4/0 Stranded	610 mm
223FJ2QA24	2Q	4/0 Stranded	610 mm
223FJ2Q36	2Q	4/0 Stranded	914 mm
223FJ2Q48	2Q	4/0 Stranded	1,219 mm
223FJ2Q120	2Q	4/0 Stranded	3,048 mm
223FJ2Q156	2Q	4/0 Stranded	3,962 mm
223FJ2Q168	2Q	4/0 Stranded	4,267 mm
223FJ2Q180	2Q	4/0 Stranded	4,572 mm
223FJ2Q216	2Q	4/0 Stranded	5,486 mm
223FJ2Q240	2Q	4/0 Stranded	6,096 mm
223FJ2Q252	2Q	4/0 Stranded	6,401 mm
223FJ2Q384	2Q	4/0 Stranded	9,754 mm
223FJ2Q600	2Q	4/0 Stranded	15,240 mm

PREFABRICATED FENCE CLAMP ASSEMBLY WITH SINGLE GROUND LEAD

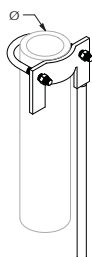

FEATURES

- deal for when Cadweld connections cannot be made to aluminum pipe or thin-wall steel tube
- Stainless steel hardware included
- Available in either left or right-hand orientation

Material: Copper, Stainless Steel 18-8 (EN 1.4305), Stainless Steel 304 (EN 1.4301)

Finish: Tinned

Part Number	Fence Post Size, Nominal	Fence Post Outside Diameter, Actual	Ground Lead Conductor Size	Ground Lead Length
Orientation: Left Hand				
223A235C2C1LH	1 1/2"	48.3 mm	1/0 Stranded	0.3 m
223A235D2G4LH	2"	60.5 mm	2/0 Stranded	1.2 m
223A235D2Q4LH	2"	60.5 mm	4/0 Stranded	1.2 m
223A235D2Q5LH	2"	60.5 mm	4/0 Stranded	1.5 m
223A235E2G4LH	2 1/2"	73.2 mm	2/0 Stranded	1.2 m
223A235E2Q4LH	2 1/2"	73.2 mm	4/0 Stranded	1.2 m
223A235E2Q5LH	2 1/2"	73.2 mm	4/0 Stranded	1.5 m
223A235F2C2LH	3"	88.9 mm	1/0 Stranded	0.6 m
Orientation: Right Hand				
223A235D2G2RH	2"	60.5 mm	2/0 Stranded	0.6 m
223A235D2Q4RH	2"	60.5 mm	4/0 Stranded	1.2 m
223A235D2Q5RH	2"	60.5 mm	4/0 Stranded	1.5 m
223A235E2Q2RH	2 1/2"	73.2 mm	4/0 Stranded	0.6 m
223A235E2Q5RH	2 1/2"	73.2 mm	4/0 Stranded	1.5 m
223A235G2Q2RH	3 1/2"	101.6 mm	4/0 Stranded	0.6 m
223A235H2C10RH	4"	114.3 mm	1/0 Stranded	3.1 m

Right hand orientation shown in diagram.

PREFABRICATED GATE JUMPER ASSEMBLY

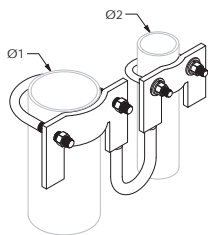

FEATURES

- Ideal for when Cadweld connections cannot be made to aluminum pipe or thin-wall steel tube
- Jumper conductor is insulated
- Stainless steel hardware included
- Available in either left or right-hand orientation

Material: Copper, Stainless Steel 18-8 (EN 1.4305), Stainless Steel 304 (EN 1.4301)

Finish: Tinned

Part Number	Fixed Gate Diameter, Nominal	Fixed Gate Diameter, Actual	Post Frame Diameter, Nominal	Post Frame Diameter, Actual	Jumper Conductor Size	Jumper Length
Orientation: Left Hand						
223A238EB2S12LH	2 1/2"	73.2 mm	1 1/4"	42.20 mm	4/0 Stranded	305 mm
223A238EC2S12LH	2 1/2"	73.2 mm	1 1/2"	48.30 mm	4/0 Stranded	305 mm
223A238EC2S24LH	2 1/2"	73.2 mm	1 1/2"	48.30 mm	4/0 Stranded	610 mm
223A238FC2S12LH	3"	88.9 mm	1 1/2"	48.30 mm	4/0 Stranded	305 mm
223A238FC2S16LH	3"	88.9 mm	1 1/2"	48.30 mm	4/0 Stranded	406 mm
223A238FC2S18LH	3"	88.9 mm	1 1/2"	48.30 mm	4/0 Stranded	457 mm
223A238FC2S24LH	3"	88.9 mm	1 1/2"	48.30 mm	4/0 Stranded	610 mm
223A238FD2S18LH	3"	88.9 mm	2"	60.50 mm	4/0 Stranded	457 mm
223A238GC2S12LH	3 1/2"	101.6 mm	1 1/2"	48.30 mm	4/0 Stranded	305 mm
223A238GC2S18LH	3 1/2"	101.6 mm	1 1/2"	48.30 mm	4/0 Stranded	457 mm
223A238GC2S24LH	3 1/2"	101.6 mm	1 1/2"	48.30 mm	4/0 Stranded	610 mm
223A238HB2S18LH	4"	114.3 mm	1 1/4"	42.16 mm	4/0 Stranded	457 mm
223A238HC2S24LH	4"	114.3 mm	1 1/2"	48.30 mm	4/0 Stranded	610 mm
223A238KC2S24LH	6"	168.4 mm	1 1/2"	48.30 mm	4/0 Stranded	610 mm
Orientation: Right Hand						
223A238EC2S12RH	2 1/2"	73.2 mm	1 1/2"	48.30 mm	4/0 Stranded	305 mm
223A238EC2S24RH	2 1/2"	73.2 mm	1 1/2"	48.30 mm	4/0 Stranded	610 mm
223A238FC2S12RH	3"	88.9 mm	1 1/2"	48.30 mm	4/0 Stranded	305 mm
223A238FC2S16RH	3"	88.9 mm	1 1/2"	48.30 mm	4/0 Stranded	406 mm
223A238FC2S18RH	3"	88.9 mm	1 1/2"	48.30 mm	4/0 Stranded	457 mm
223A238FC2S24RH	3"	88.9 mm	1 1/2"	48.30 mm	4/0 Stranded	610 mm
223A238FD2S18RH	3"	88.9 mm	2"	60.50 mm	4/0 Stranded	457 mm
223A238FF2S12RH	3"	88.9 mm	3"	88.90 mm	4/0 Stranded	305 mm
223A238GC2S12RH	3 1/2"	101.6 mm	1 1/2"	48.30 mm	4/0 Stranded	305 mm
223A238GC2S18RH	3 1/2"	101.6 mm	1 1/2"	48.30 mm	4/0 Stranded	457 mm
223A238GC2S24RH	3 1/2"	101.6 mm	1 1/2"	48.30 mm	4/0 Stranded	610 mm
223A238GD2S24RH	3 1/2"	101.6 mm	2"	60.50 mm	4/0 Stranded	610 mm
223A238HB2S18RH	4"	114.3 mm	1 1/4"	42.16 mm	4/0 Stranded	457 mm
223A238HD2S24RH	4"	114.3 mm	2"	60.50 mm	4/0 Stranded	610 mm
223A238KC2S24RH	6"	168.4 mm	1 1/2"	48.30 mm	4/0 Stranded	610 mm
223A238KD2S24RH	6"	168.4 mm	2"	60.50 mm	4/0 Stranded	610 mm

"Fixed gate" refers to the pipe on the fence itself, while "post frame" refers to the post on the swinging door. Left hand orientation shown in diagram.

PREFABRICATED GATE JUMPER ASSEMBLY WITH GROUND LEADS

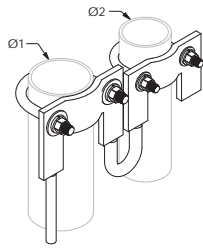

FEATURES

- Ideal for when Cadweld connections cannot be made to aluminum pipe or thin-wall steel tube
- Jumper conductor is insulated
- Stainless steel hardware included
- Available in either left or right-hand orientation

Material: Copper, Stainless Steel 18-8 (EN 1.4305), Stainless Steel 304 (EN 1.4301)
 Finish: Tinned

Part Number	Fixed Gate Diameter, Nominal	Fixed Gate Diameter, Actual	Post Frame Diameter, Nominal	Post Frame Diameter, Actual	Jumper Conductor Size	Jumper Length	Ground Lead Conductor Size	Ground Lead Length
Orientation: Left Hand								
223A239DC2S242C4LH	2"	60.5 mm	1 1/2"	48.3 mm	4/0 Stranded	610 mm	1/0 Stranded	1,219 mm
223A239EC2S182Q6LH	2 1/2"	73.2 mm	1 1/2"	48.3 mm	4/0 Stranded	457 mm	4/0 Stranded	1,829 mm
223A239EC2S242C4LH	2 1/2"	73.2 mm	1 1/2"	48.3 mm	4/0 Stranded	610 mm	1/0 Stranded	1,219 mm
223A239EC2S242G8LH	2 1/2"	73.2 mm	1 1/2"	48.3 mm	4/0 Stranded	610 mm	2/0 Stranded	2,438 mm
223A239EC2S242Q4LH	2 1/2"	73.2 mm	1 1/2"	48.3 mm	4/0 Stranded	610 mm	4/0 Stranded	1,219 mm
223A239FC2S242C2LH	3"	88.9 mm	1 1/2"	48.3 mm	4/0 Stranded	610 mm	1/0 Stranded	610 mm
223A239FC2S242G4LH	3"	88.9 mm	1 1/2"	48.3 mm	4/0 Stranded	610 mm	2/0 Stranded	1,219 mm
223A239FC2S242G5LH	3"	88.9 mm	1 1/2"	48.3 mm	4/0 Stranded	610 mm	2/0 Stranded	1,524 mm
223A239FC2S242Q10L	3"	88.9 mm	1 1/2"	48.3 mm	4/0 Stranded	610 mm	4/0 Stranded	3,048 mm
223A239FC2S242Q2LH	3"	88.9 mm	1 1/2"	48.3 mm	4/0 Stranded	610 mm	4/0 Stranded	610 mm
223A239FC2S242Q4LH	3"	88.9 mm	1 1/2"	48.3 mm	4/0 Stranded	610 mm	4/0 Stranded	1,219 mm
223A239FC2S242Q8LH	3"	88.9 mm	1 1/2"	48.3 mm	4/0 Stranded	610 mm	4/0 Stranded	2,438 mm
223A239FD2S241V1LH	3"	88.9 mm	2"	60.5 mm	4/0 Stranded	610 mm	#2 Stranded	305 mm
223A239FD2S242G4LH	3"	88.9 mm	2"	60.5 mm	4/0 Stranded	610 mm	2/0 Stranded	1,219 mm
223A239GC2S242Q4LH	3 1/2"	101.6 mm	1 1/2"	48.3 mm	4/0 Stranded	610 mm	4/0 Stranded	1,219 mm
223A239HC2S182C5LH	4"	114.3 mm	1 1/2"	48.3 mm	4/0 Stranded	457 mm	1/0 Stranded	1,524 mm
223A239HC2S182Q6LH	4"	114.3 mm	1 1/2"	48.3 mm	4/0 Stranded	457 mm	4/0 Stranded	1,829 mm
223A239HC2S242C10L	4"	114.3 mm	1 1/2"	48.3 mm	4/0 Stranded	610 mm	1/0 Stranded	3,048 mm
223A239HC2S242C4LH	4"	114.3 mm	1 1/2"	48.3 mm	4/0 Stranded	610 mm	1/0 Stranded	1,219 mm
223A239HC2S242G30L	4"	114.3 mm	1 1/2"	48.3 mm	4/0 Stranded	610 mm	2/0 Stranded	9,144 mm
223A239HC2S242G4LH	4"	114.3 mm	1 1/2"	48.3 mm	4/0 Stranded	610 mm	2/0 Stranded	1,219 mm
223A239HC2S242G5LH	4"	114.3 mm	1 1/2"	48.3 mm	4/0 Stranded	610 mm	2/0 Stranded	1,524 mm
223A239HC2S242Q2LH	4"	114.3 mm	1 1/2"	48.3 mm	4/0 Stranded	610 mm	4/0 Stranded	610 mm
223A239HD2S242Q2LH	4"	114.3 mm	2"	60.5 mm	4/0 Stranded	610 mm	4/0 Stranded	610 mm
223A239HD2S242Q5LH	4"	114.3 mm	2"	60.5 mm	4/0 Stranded	610 mm	4/0 Stranded	1,524 mm
Orientation: Right Hand								
223A239EB2S242Q4RH	2 1/2"	73.2 mm	1 1/4"	42.2 mm	4/0 Stranded	610 mm	4/0 Stranded	1,219 mm
223A239EC2S242C4RH	2 1/2"	73.2 mm	1 1/2"	48.3 mm	4/0 Stranded	610 mm	1/0 Stranded	1,219 mm
223A239EC2S242Q4RH	2 1/2"	73.2 mm	1 1/2"	48.3 mm	4/0 Stranded	610 mm	4/0 Stranded	1,219 mm
223A239FC2S122G24R	3"	88.9 mm	1 1/2"	48.3 mm	4/0 Stranded	305 mm	2/0 Stranded	7,315 mm
223A239FC2S242C2RH	3"	88.9 mm	1 1/2"	48.3 mm	4/0 Stranded	610 mm	1/0 Stranded	610 mm
223A239FC2S242G4RH	3"	88.9 mm	1 1/2"	48.3 mm	4/0 Stranded	610 mm	2/0 Stranded	1,219 mm
223A239FC2S242G5RH	3"	88.9 mm	1 1/2"	48.3 mm	4/0 Stranded	610 mm	2/0 Stranded	1,524 mm
223A239FC2S242Q4RH	3"	88.9 mm	1 1/2"	48.3 mm	4/0 Stranded	610 mm	4/0 Stranded	1,219 mm
223A239FD2S242G4RH	3"	88.9 mm	2"	60.5 mm	4/0 Stranded	610 mm	2/0 Stranded	1,219 mm
223A239GC2S242Q4RH	3 1/2"	101.6 mm	1 1/2"	48.3 mm	4/0 Stranded	610 mm	4/0 Stranded	1,219 mm
223A239HB2S242Q1RH	4"	114.3 mm	1 1/4"	42.2 mm	4/0 Stranded	610 mm	4/0 Stranded	305 mm
223A239HC2S182C5RH	4"	114.3 mm	1 1/2"	48.3 mm	4/0 Stranded	457 mm	1/0 Stranded	1,524 mm
223A239HC2S242C10R	4"	114.3 mm	1 1/2"	48.3 mm	4/0 Stranded	610 mm	1/0 Stranded	3,048 mm
223A239HC2S242C4RH	4"	114.3 mm	1 1/2"	48.3 mm	4/0 Stranded	610 mm	1/0 Stranded	1,219 mm
223A239HC2S242G3OR	4"	114.3 mm	1 1/2"	48.3 mm	4/0 Stranded	610 mm	2/0 Stranded	9,144 mm
223A239HC2S242G5RH	4"	114.3 mm	1 1/2"	48.3 mm	4/0 Stranded	610 mm	2/0 Stranded	1,524 mm
223A239HC2S242Q2RH	4"	114.3 mm	1 1/2"	48.3 mm	4/0 Stranded	610 mm	4/0 Stranded	610 mm
223A239HD2S242Q2RH	4"	114.3 mm	2"	60.5 mm	4/0 Stranded	610 mm	4/0 Stranded	610 mm
223A239HD2S242Q5RH	4"	114.3 mm	2"	60.5 mm	4/0 Stranded	610 mm	4/0 Stranded	1,524 mm
223A239KD2S242Q4RH	6"	114.3 mm	2"	60.5 mm	4/0 Stranded	610 mm	4/0 Stranded	1,219 mm

"Fixed gate" refers to the pipe on the fence itself, while "post frame" refers to the post on the swinging door. Left hand orientation shown in diagram.

REBAR GROUNDING CLAMP, PARALLEL

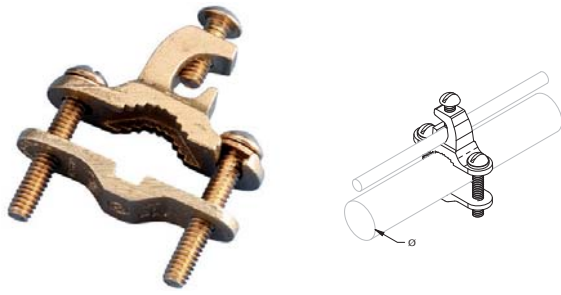

FEATURES

- Universal use for rebar, rods or pipes
- Lay-in feature cuts installation time
- Bronze alloy construction with Stainless Steel 304 screws
- Approved for direct burial in earth and concrete

Material: Bronze, Stainless Steel 304 (EN 1.4301)

Connection Type: Parallel

Conductor Size:



Part Number	Article Number	Ground Rod Diameter, Actual	Water Pipe Size	Rebar Size, Metric	Rebar Size, US	Rebar Size, Canada
223EK16	710355	12.7 – 25.4 mm	12.7 – 25.4 mm	12 – 25 mm	#4 – #8	10M – 25M

REBAR GROUNDING CLAMP, PERPENDICULAR

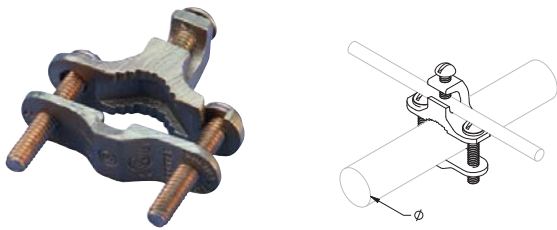

FEATURES

- Universal use for rebar, rods or pipes
- Lay-in feature cuts installation time
- Bronze alloy construction with Stainless Steel 304 screws
- Approved for direct burial in earth and concrete

Material: Bronze, Stainless Steel 304 (EN 1.4301)

Connection Type: Perpendicular

Conductor Size:



Part Number	Article Number	Ground Rod Diameter, Actual	Water Pipe Size	Rebar Size, Metric	Rebar Size, US	Rebar Size, Canada
223EK17	710365	12.7 – 25.4 mm	12.7 – 25.4 mm	12 – 25 mm	#4 – #8	10M – 25M

REBAR GROUNDING CLAMP, HEAVY DUTY



FEATURES

- Provides two connection points to concrete encased electrodes (rebar) for states where the Authority Having Jurisdiction (AHJ) requires it
- Meets 2005 NEC[®] standard requirement for bonding to rebar into the grounding system
- Has high-strength bronze alloy construction
- Easy to install

Material: Bronze



Part Number	Article Number	Rebar Size, Metric	Rebar Size, US	Rebar Size, Canada
Conductor Size: #8 Solid - 2/0 Stranded, 10 mm ² Stranded - 70 mm ² Stranded				
223RC70	710325	8 – 18 mm	#3 – #6	10M – 20M
Conductor Size: #8 Solid - 4/0 Stranded, 10 mm ² Stranded - 100 mm ² Stranded				
223RC100	710335	18 – 36 mm	#6 – #11	20M – 35M

REBAR BONDING CLAMP

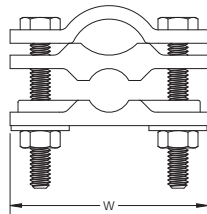

FEATURES

- Provides bond from lightning protection system to rebar

Material: Brass

Conductor Size, UL: Class 2 (4/0 Max)



Part Number	Rebar Size, Canada	Rebar Size, Metric	Rebar Size, US	Depth	Width	Unit Weight
223LPC466	10M Max	29 mm Max	#9 Max	31.7 mm	63.5 mm	0.279 kg

ARC WELDABLE BOND



FEATURES

- 19-strand concentric cable flash-welded to steel rod for a bonding connection to structural steel and to rebar
- Economical alternative to exothermic welding when only a few connections need to be made and an arc welder is available on site
- Rod is sized to match the ampacity of the cable for fault currents

Material: Copper, Steel

Part Number	Conductor Size	Cable Length	Rod Size	Rod Length
223EWB2G9164	2/0 Stranded	1.2 m	14 mm	203 mm
223EWB2L584	3/0 Stranded	1.2 m	16 mm	203 mm
223EWB2Q344	4/0 Stranded	1.2 m	19 mm	203 mm
223EWBCS701	70 mm ² Stranded	1.0 m	12 mm	203 mm

UNIVERSAL PEDESTAL CLAMP WITH CABLE MANAGEMENT, MBNUPCJ240

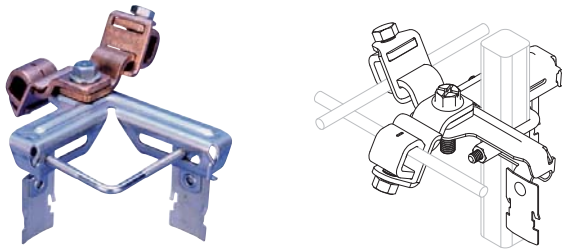

FEATURES

- Only one attachment required for both mesh bonding and cable management
- Eliminates the need for separate mounting brackets for different pedestal types or sizes
- Stainless steel construction of bracket and hardware reduces potential for galvanic corrosion
- Mesh bonding conductors do not have to bend around each pedestal to conform to grid pattern
- Suitable for round or square pedestals

Material: Copper, Steel, Stainless Steel 304 (EN 1.4301)

Finish: nVent CADDY Armour, Electrogalvanized



Part Number	Conductor Size	Pedestal Size	Standard Packaging Quantity
223MBNUPCJ240	#2 Solid - 4/0 Stranded, 35 mm ² - 100 mm ²	22 - 51 mm Round or Square	25 pc

UNIVERSAL PEDESTAL CLAMP WITH CABLE MANAGEMENT, MBNUPCJ82

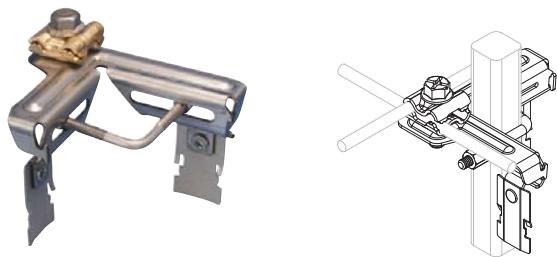

FEATURES

- Only one attachment required for both mesh bonding and cable management
- Eliminates the need for separate mounting brackets for different pedestal types or sizes
- Stainless steel construction of bracket and hardware reduces potential for galvanic corrosion
- Mesh bonding conductors do not have to bend around each pedestal to conform to grid pattern
- Suitable for round or square pedestals

Material: Bronze, Steel, Stainless Steel 304 (EN 1.4301)

Finish: nVent CADDY Armour, Electrogalvanized



Part Number	Conductor Size	Pedestal Size	Standard Packaging Quantity
223MBNUPCJ82	#8 Solid - #2 Stranded, 10 mm ² Solid - 35 mm ² Stranded	22 - 51 mm Round or Square	25 pc

SRG CONNECTOR PEDESTAL MOUNTING BRACKET



FEATURES

- Mounts SRGC46 connector to square or round pedestals
- Simplifies retrofit installations

Material: Stainless Steel 304 (EN 1.4301), Bronze



Part Number	Article Number	Pedestal Size	Standard Packaging Quantity
223SRGC46BR	167906	22 mm Square; 25 mm Round	10 pc

COPPER LUG MECHANICAL CONNECTOR

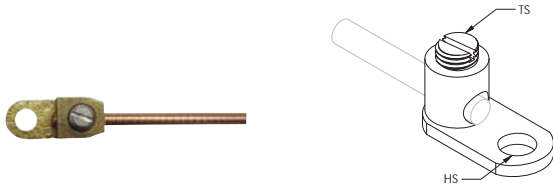

FEATURES

- Simple to use and install
- Suitable for telecom and equipotential bonding applications



Material: Copper

Part Number	Conductor Size	Thread Size	Hole Size
223EL4	#14 Solid - #4 Stranded, 2.5 mm ² Stranded - 16 mm ² Stranded	5/16 UNF	7.2 mm

FLUSH MOUNT POSITIONER, SOLID ROUND CONDUCTOR



FEATURES

- Flush-mount positioning clamps for use with solid round conductors, including Cu-Bond Round Conductor
- For use with copper-bonded, copper, or stainless steel solid conductors

Material: Stainless Steel 18-8 (EN 1.4305), Stainless Steel 316 (EN 1.4401)

Part Number	Width 1	Width 2	Height 1	Height 2	Depth	Cu-Bond Conductor	Unit Weight	Complies With
223CSS0810000	95 mm	80 mm	20 mm	5 mm	17 mm	CBSC8, CBSC10	0.009 kg	IEC [®] 62561-4
223CSS1314000	95 mm	80 mm	20 mm	5 mm	17 mm	CBSC13, CBSC14	0.009 kg	IEC [®] 62561-4
223CSS1618000	95 mm	80 mm	25 mm	5 mm	17 mm	CBSC16, CBSC18	0.009 kg	IEC [®] 62561-4

IEC compliance is valid only for Cu-Bond Conductors listed.

50 MM OFFSET POSITIONER, SOLID ROUND CONDUCTOR

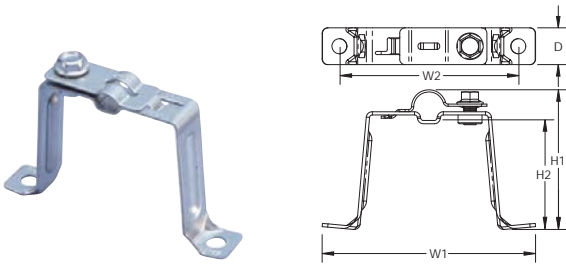

FEATURES

- Positioning clamps with 50 mm (1.97") offset for use with solid round conductors, including Cu-Bond Round Conductor
- For use with copper-bonded, copper, or stainless steel solid conductors

Material: Stainless Steel 18-8 (EN 1.4305), Stainless Steel 316 (EN 1.4401)

Part Number	Width 1	Width 2	Height 1	Height 2	Depth	Cu-Bond Conductor	Unit Weight	Complies With
223CSS0810050	100 mm	80 mm	65 mm	50 mm	17 mm	CBSC8, CBSC10	0.011 kg	IEC * 62561-4
223CSS1314050	100 mm	80 mm	65 mm	50 mm	17 mm	CBSC13, CBSC14	0.011 kg	IEC * 62561-4
223CSS1618050	100 mm	80 mm	70 mm	50 mm	17 mm	CBSC16, CBSC18	0.011 kg	IEC * 62561-4

IEC compliance is valid only for Cu-Bond Conductors listed.

150 MM OFFSET POSITIONER, SOLID ROUND CONDUCTOR

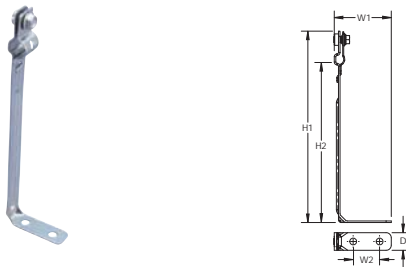

FEATURES

- Positioning clamps with 150 mm (5.9") offset for use with solid round conductors, including Cu-Bond Round Conductor
- For use with copper-bonded, copper, or stainless steel solid conductors
- Ideal for use in positioning solid round conductor in a horizontal orientation, such as on a roof or parapet

Material: Stainless Steel 18-8 (EN 1.4305), Stainless Steel 316 (EN 1.4401)

Part Number	Width 1	Width 2	Height 1	Height 2	Depth	Cu-Bond Conductor	Unit Weight	Complies With
223CSS0810150	55 mm	25 mm	185 mm	150 mm	17 mm	CBSC8, CBSC10	0.013 kg	IEC * 62561-4
223CSS1314150	55 mm	25 mm	185 mm	150 mm	17 mm	CBSC13, CBSC14	0.013 kg	IEC * 62561-4

IEC compliance is valid only for Cu-Bond Conductors listed.

THEFT DETERRENT COMPOSITE CABLE CLIP



FEATURES

- Compatible with CC5A04 Theft Deterrent Composite Cable

Material: Aluminum

Part Number	Conductor Size	Hole Size
223CCL04A	#14 Solid - 2/0 Solid, 2.5 mm ² Stranded - 10 mm ² Stranded	5.1 mm

Available From:

Noremak Industries Pty Ltd
1 Ledger Road Beverley SA 5009
PH 08 8244 7288 Fax 08 8244 7299 sales@noremak.com.au
www.noremak.com.au

Our powerful portfolio of brands:

CADDY ERICO HOFFMAN RAYCHEM SCHROFF TRACER



©2018 nVent. All nVent marks and logos are owned or licensed by nVent Services GmbH or its affiliates. All other trademarks are the property of their respective owners. nVent reserves the right to change specifications without notice.

ERICO-CAT-E1290B-E127LT17WWEN-EN-1805